



Explore | Connect | Educate

 **IDWeek**

Oct. 19 – 23

[idweek.org](http://idweek.org)

**IDSA**  
Infectious Diseases  
Society of America

  
**SHEA**  
The Society for Healthcare  
Epidemiology of America

**hivma**  
hiv medicine association



**PEDIATRIC  
INFECTIOUS  
DISEASES  
SOCIETY**

 **SIDP**  
SOCIETY OF INFECTIOUS  
DISEASES PHARMACISTS

# Marriott Marquis Opportunities

- Lvl 2 **Meeting Rooms** | Mezzanine visible from Main Lobby
- M1 **Meeting Room Lvl 1** | Pass through
- M2 **Meeting Room Lvl 2** | Walkway to Convention Center | Mentorship Luncheon
- M3 **Meeting Lvl 3** | Board mtgs likely
- M4 **Meeting Lvl 4** | Satellite symposia, presentation theaters, industry education evenings, program director mtg + dinner

**All IDWeek 2022 opportunities at the Marriott Marquis  
will be printed and installed by FedEx.**

# Mezzanine Level 2

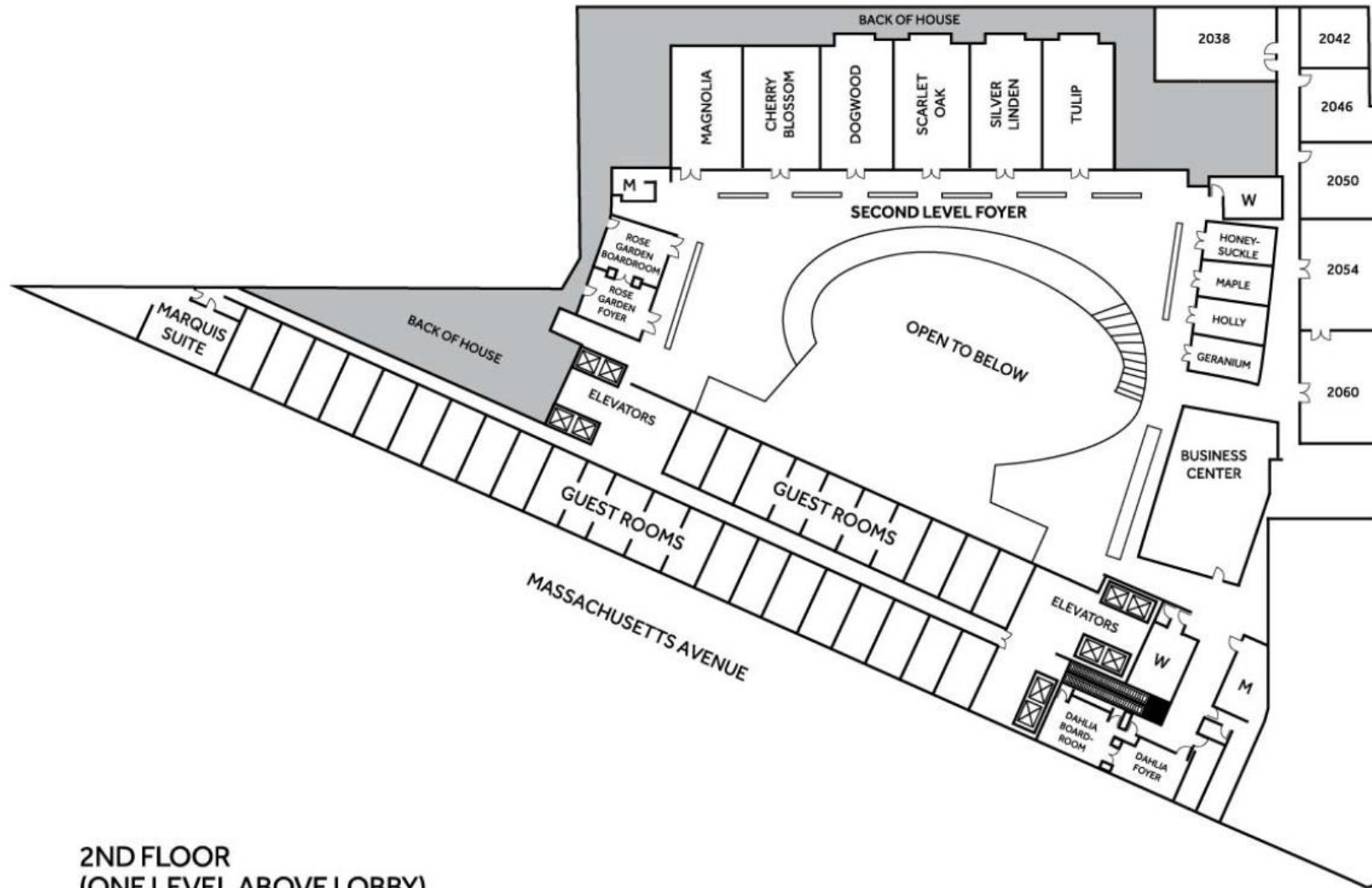

2ND FLOOR  
(ONE LEVEL ABOVE LOBBY)

Meeting Rooms  
Headers (Cherry Blossom, Dogwood, Scarlet Oak, Silver Linden, Tulip, Magnolia Room  
\$48,000

36" x 36" Mezzanine  
Double-Sided Glass  
Clings 24 available to  
single sponsor  
\$47,000





# Mezzanine Level



# M1 Level

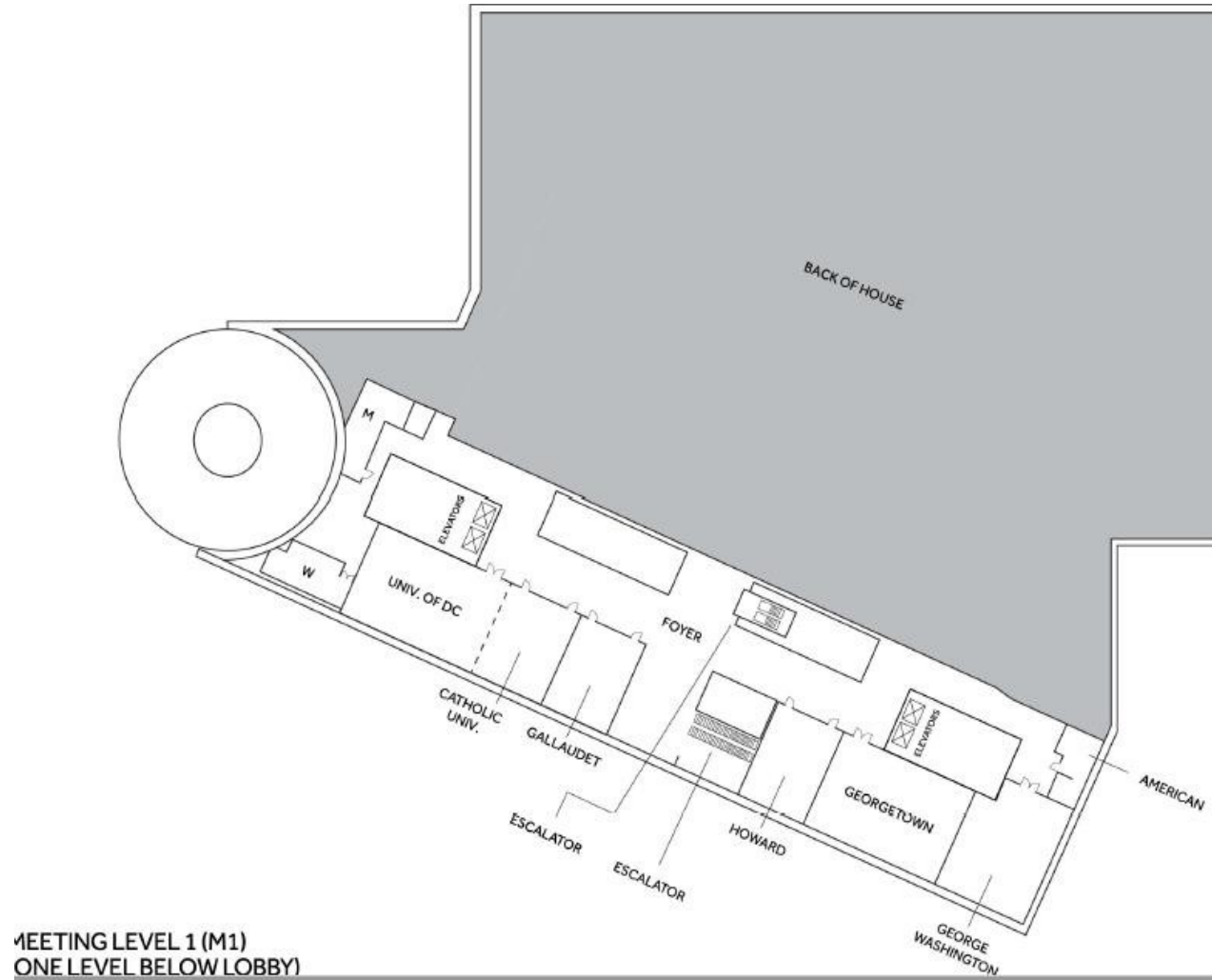



**Meeting Room Elevators  
M1 - M4 Headers + Door  
\$28,000 ea. level**





# SAMPLES





### Escalator from Lobby to M1

- 5 visible sides-recommend to do double sided cling inside 4 and 5
- 4 interior panels and 1 exterior  
\$54,000

- Glass in front of Escalators  
\$15,000





# SAMPLES



### Glass in front Concrete Wall

- Full cling- \$15,000



### M1 Concrete Wall - Full Cling

- Full Coverage top to bottom  
\$52,000





# SAMPLE





# M2 Level

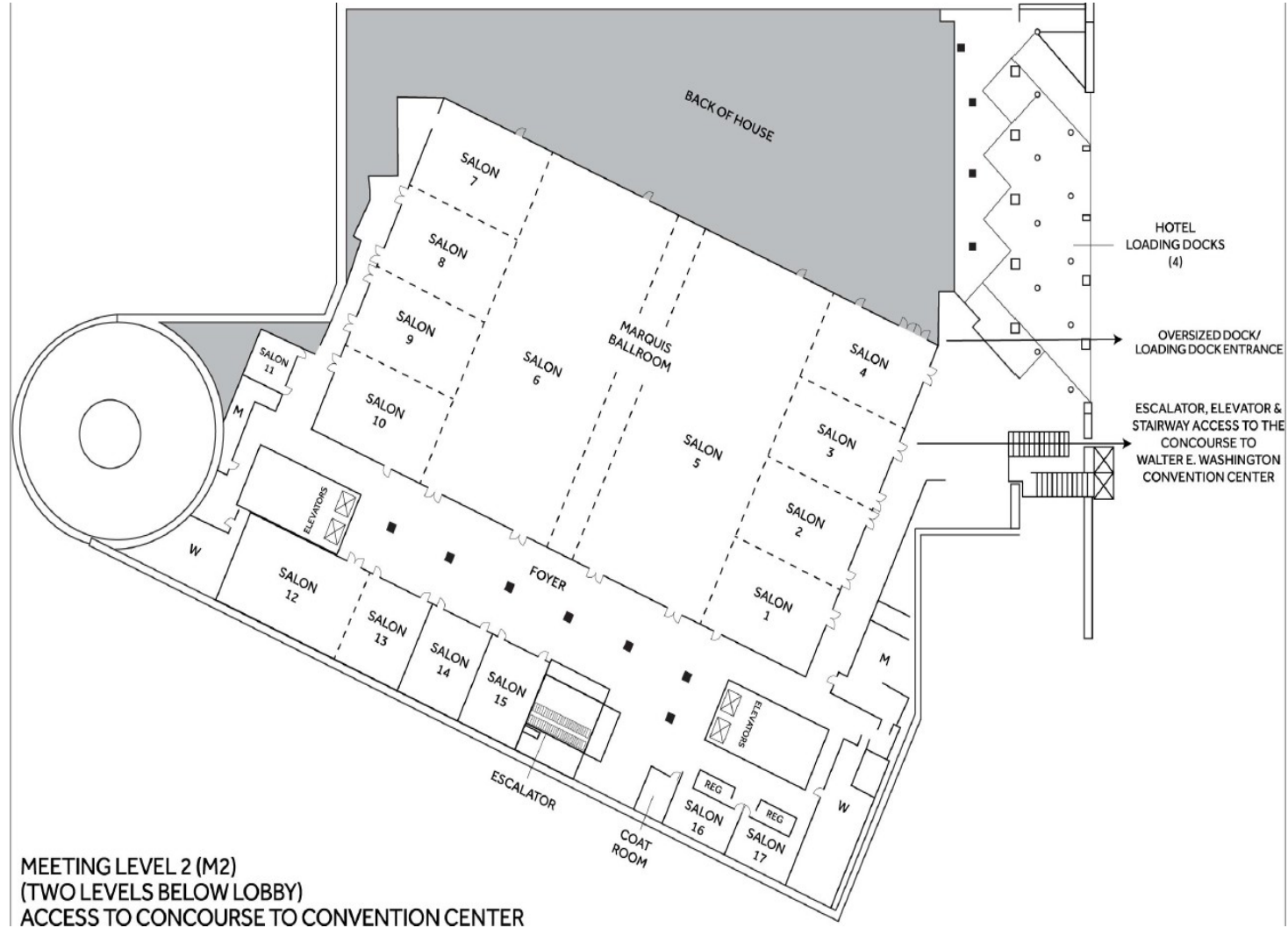



## Escalator from M1 to M2

- 5 visible sides-recommended to brand double sided cling inside 4 and 5
- Covers full glass side- top to bottom
- 4 interior panels and 1 exterior  
\$47,000

# Full Escalator Sample





## **SAMPLES OVERHEAD GLASS CLINGS ABOVE THE ESCALATOR M1- M4 & SIDE OF THE ESCALATOR AVAILABLE ON M2 - M4**

**Side \$8,000 ea. level M2-M4**

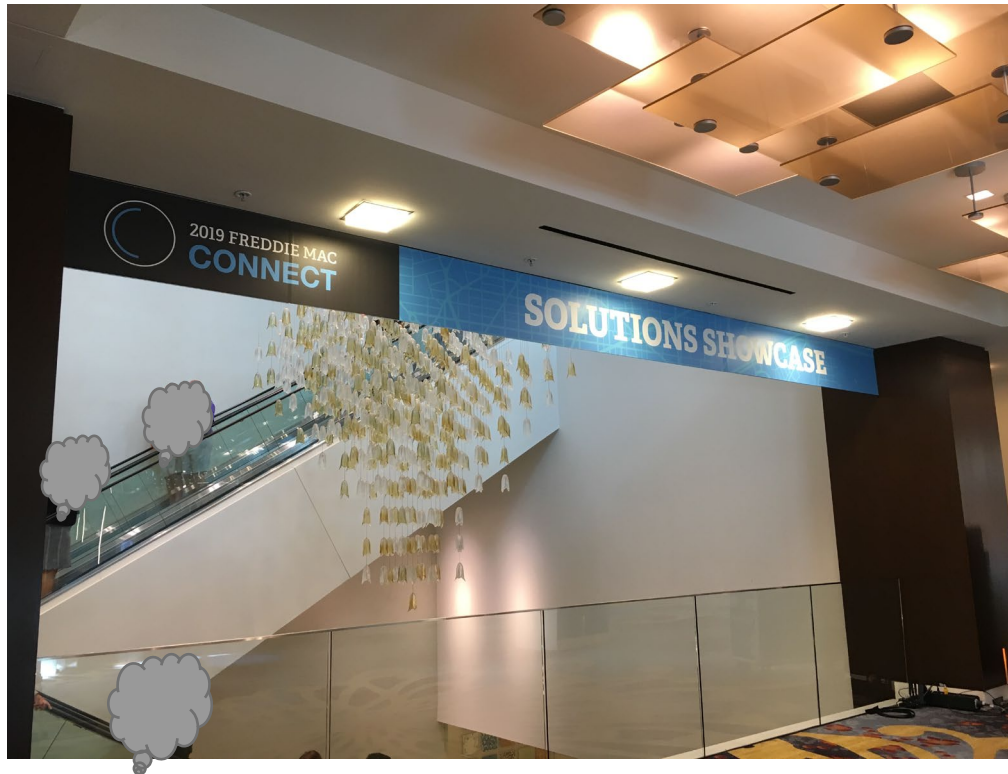

**Above \$8,000 ea. level M1-M4**

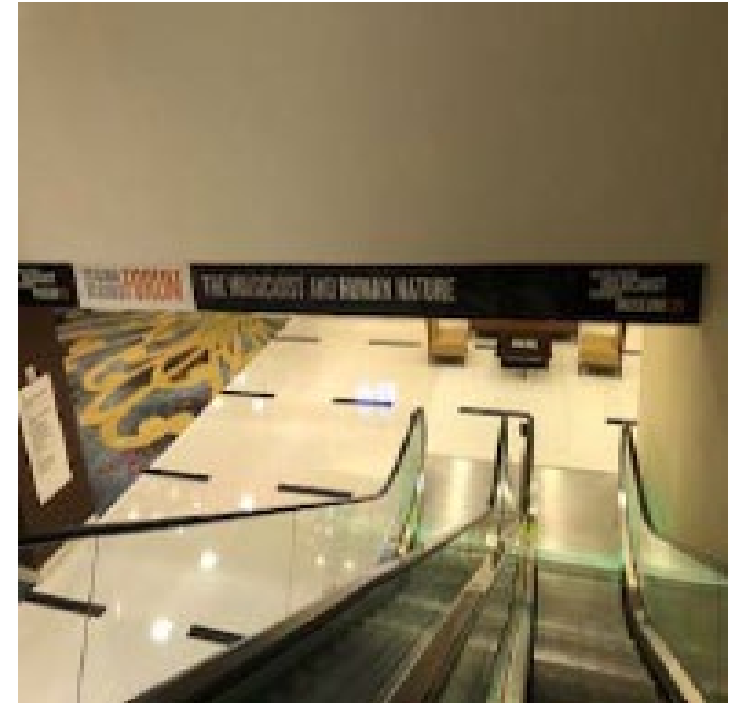

## M2 End of Corridor Wall - \$37,000

SAMPLE





- Double sided glass cling in front of ballrooms a,b,c and d
- Wall 1 + Wall 2  
\$64,000

## SAMPLE

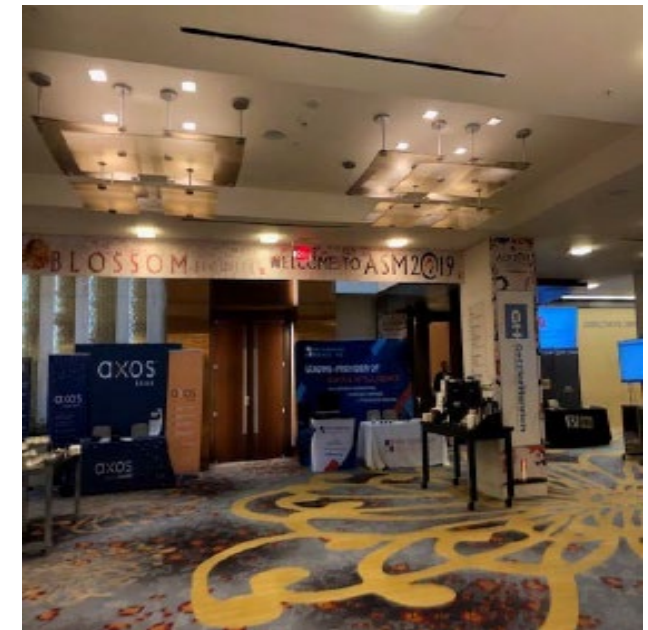



# SAMPLE



SAMPLE

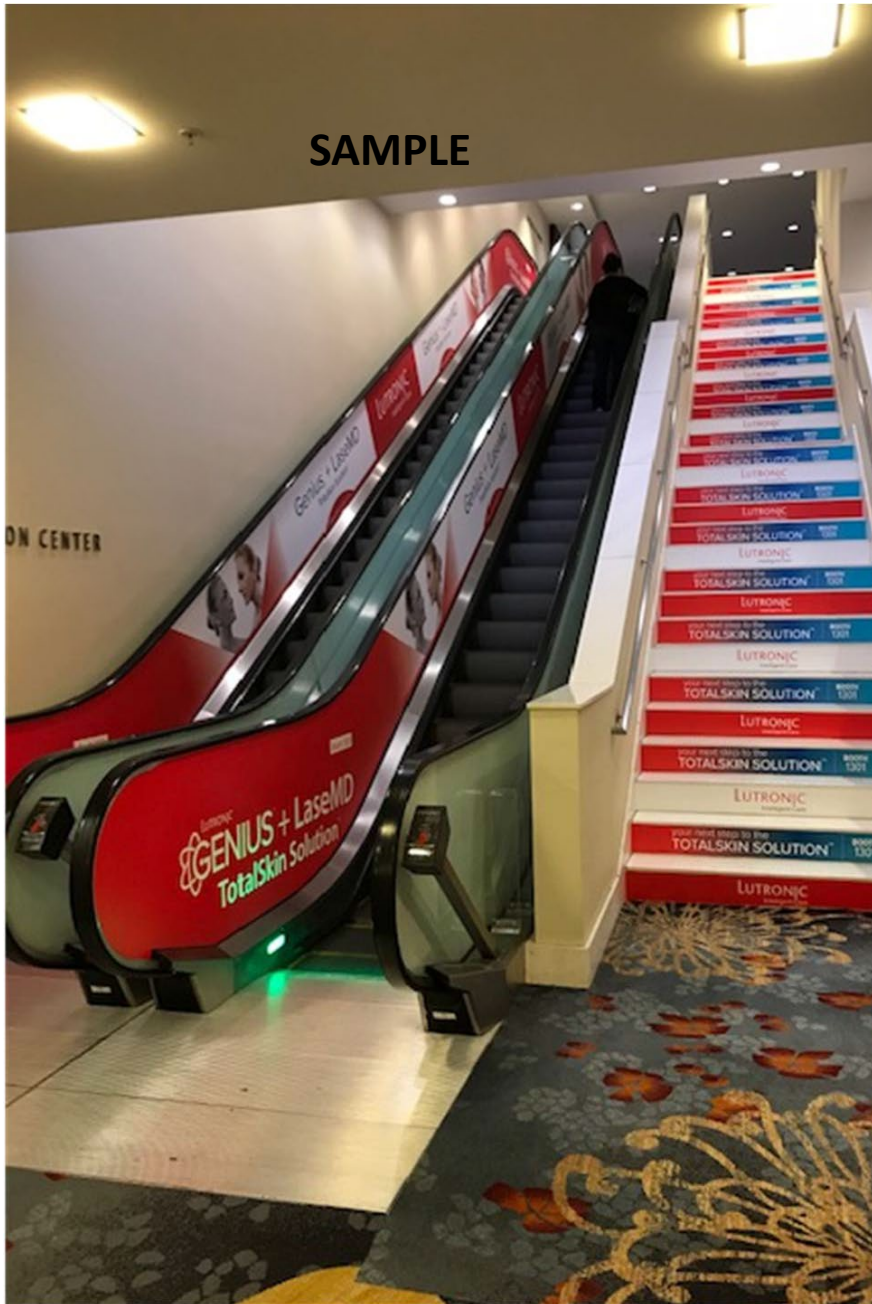

Convention Center Escalator/Stair Package  
Located on M2 towards the back  
\$49,500

# M3 Level

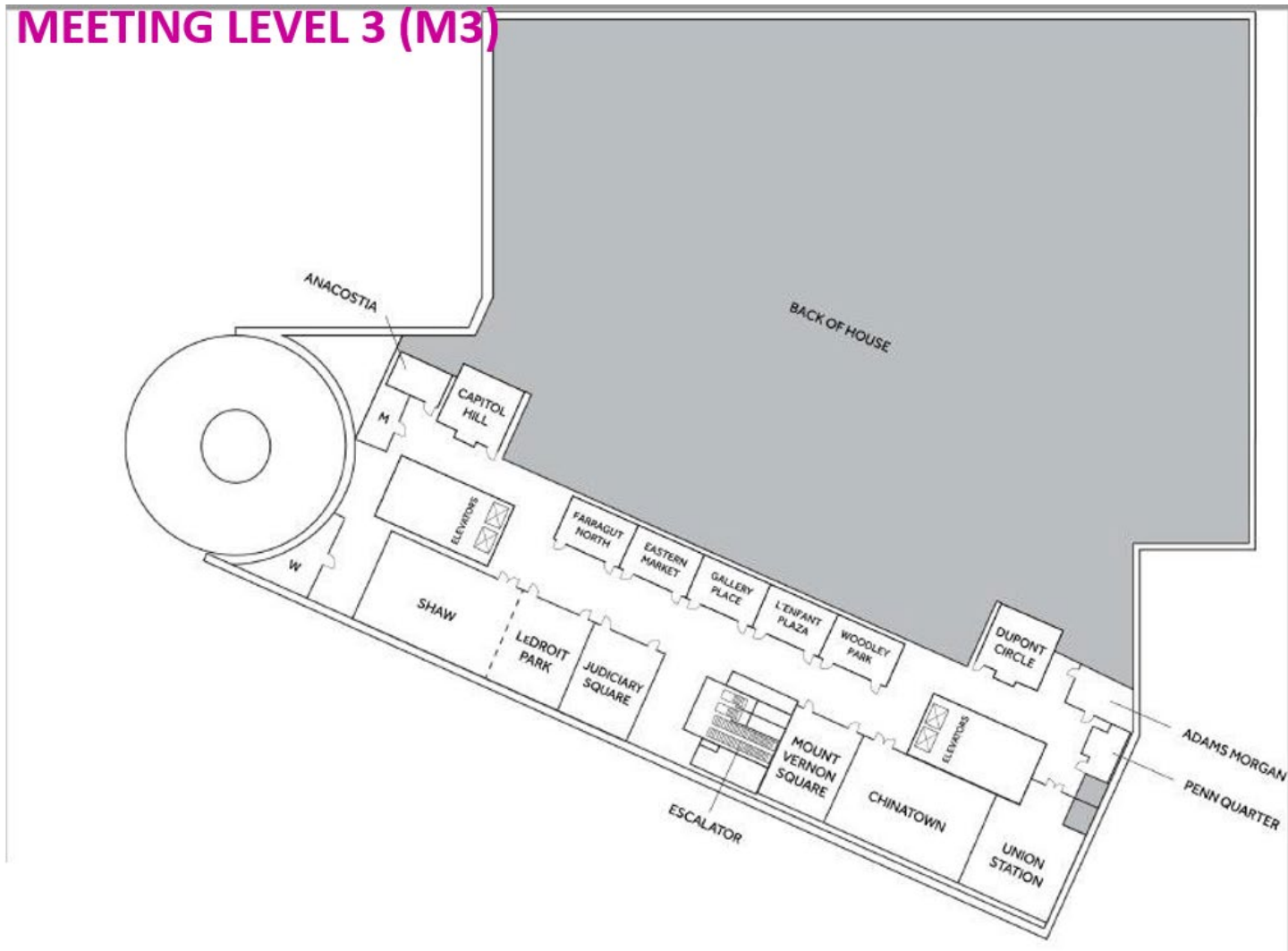



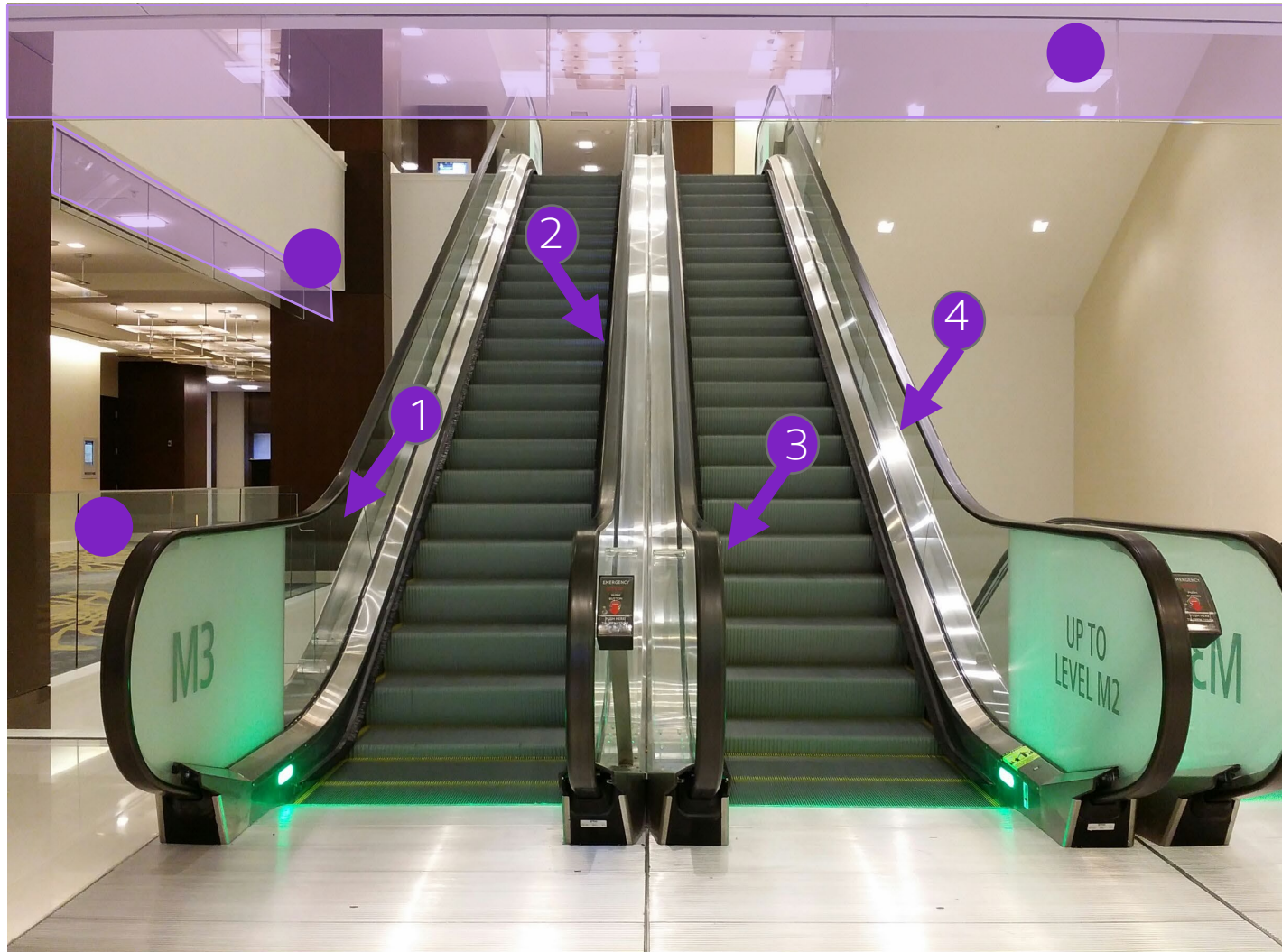

## Escalator from M2 to M3

- **2 visible sides-recommend to do double sided cling inside 1 and 4**
- **4 interior and 2 exterior panels**  
**\$47,000**



- **Large Glass next to Escalators**  
**\$15,000**

# M4 Level

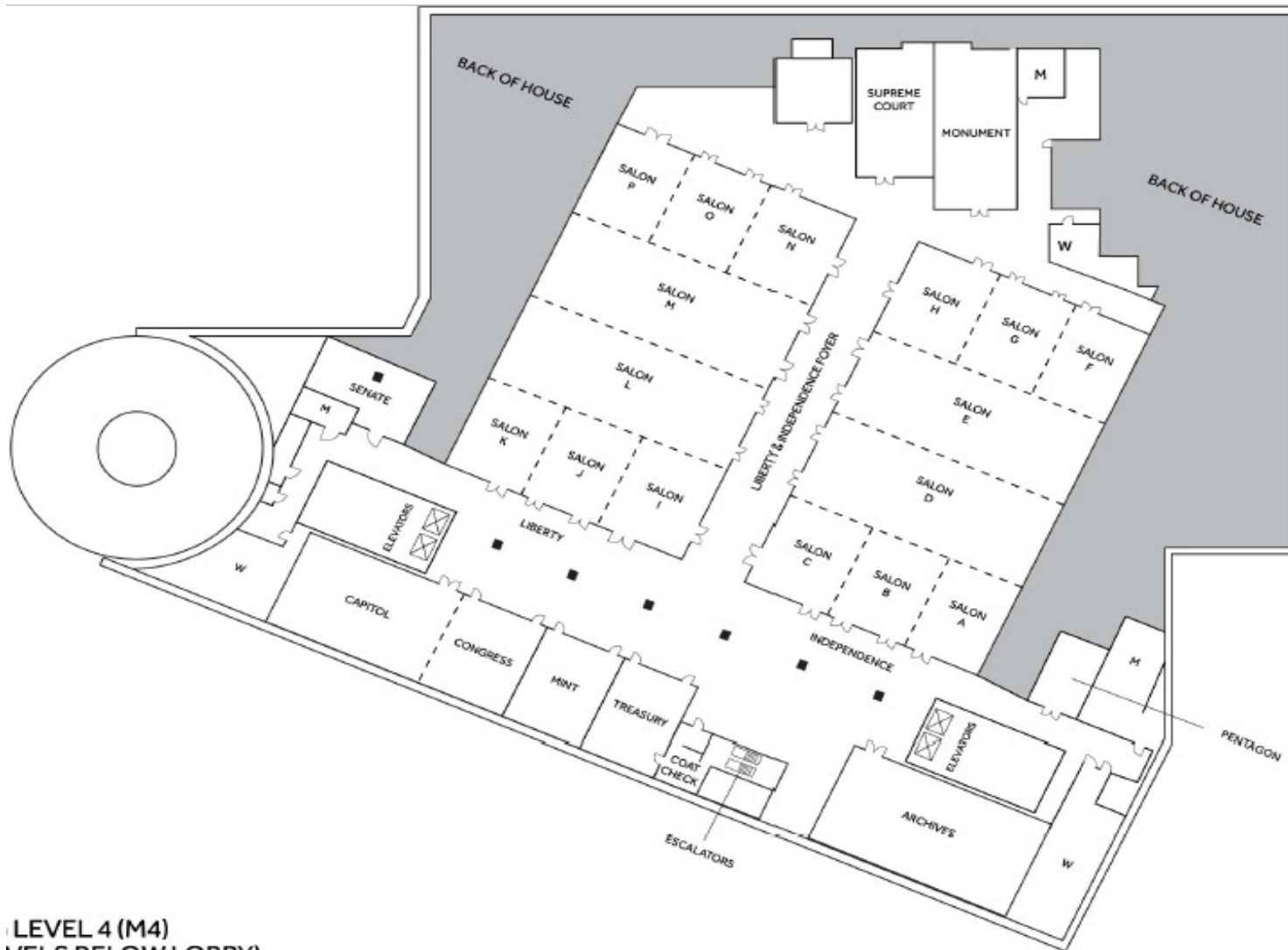

LEVEL 4 (M4)  
VEILS BELOW LOBBY





## Escalator from M3 to M4

- Panel 4-recommended to be double-sided. Otherwise, the background is white.
- 4 interior and 1 exterior panels - \$47,000